

- ① Displayer
- ② Setup Key
- ③ UP
- ④ DOWN Key
- ⑤ ON/OFF Key

Run mode define

- Standby mode: the displayer display current time.
- Sleep mode: the displayer off, click the ON/OFF key exit Sleep mode to Standby mode.
- Setup mode: setup one of option ,the displayer blink the data.
- Heating mode: the displayer display On character.

Instruction

- Turn on the Heater : While the Controller on the STANDBY mode Pushed the ON/OFF Key greater than 3s to turn ON the heater.
- Turn off the Heater : While the Controller on the Heating mode Pushed the ON/OFF Key greater than 3s to turn OFF the heater.

Setup

When the controller on the STANDBY mode click the Up or the DOWN key to select the set option. then pushed the SETUP key greater than 3s into

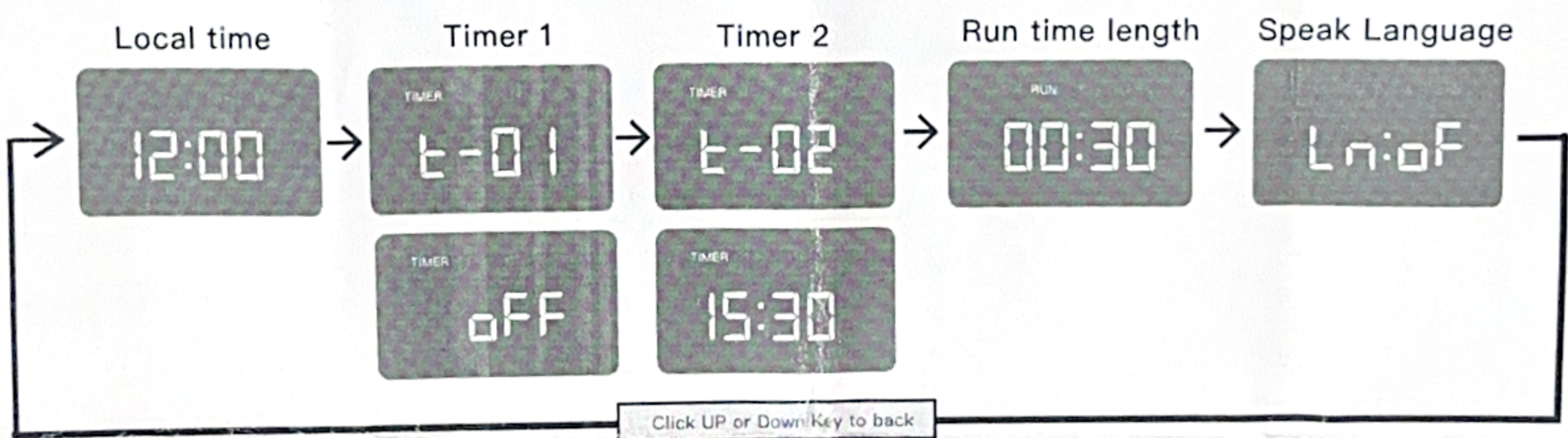

Local time



!
After power-on, the time defaults 12: 00

● Timer 1 / Timer 2

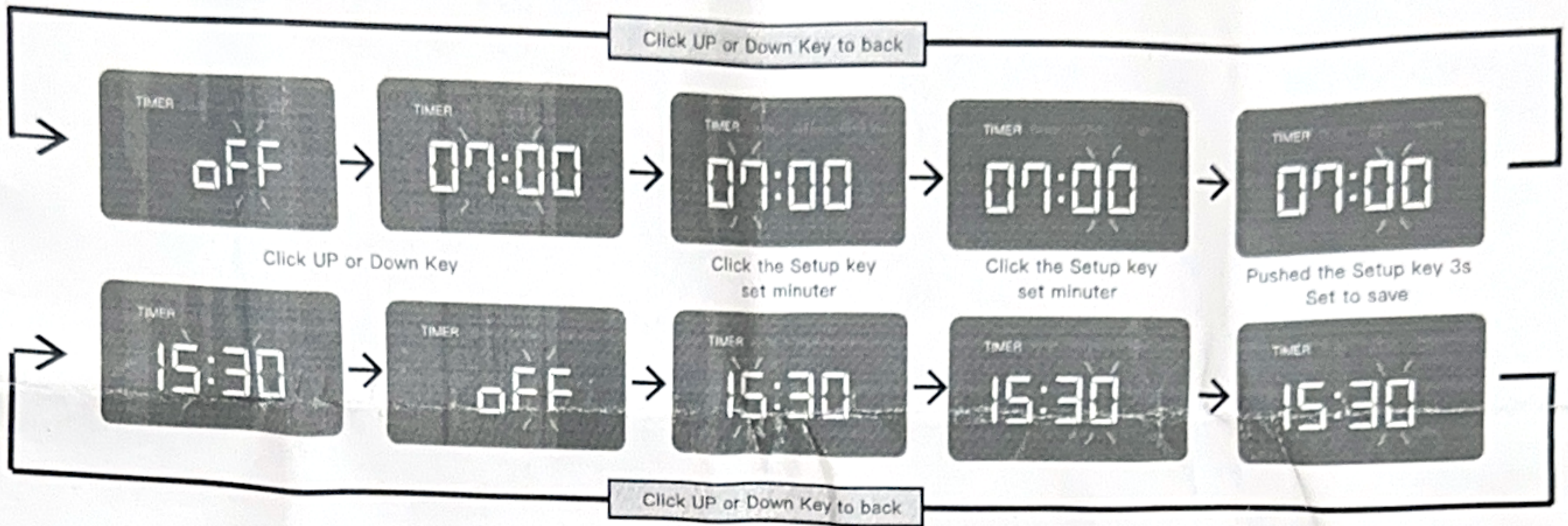

● Run time length



④ Dimension&Install

